

SmartMonitor™ Series

SmartMonitor™ Plugs & Connectors Constantly Monitors These Conditions:

- No Ground • Loss of Ground In Cord • Hot/Neutral Swap • Reverse Polarity • Hot on Ground • Open Neutral

Features Of All SmartMonitor™ Plugs & Connectors:

- Super Bright LED Technology
- SmartMonitor™ Module
- Keyed body and cover
- Easy to wire
- Clear internal wiring cover
- Non-slip finger grips
- Color coded terminal screws
- Multiple cord grommets included
- Rubberized outer body
- Safety Yellow and Blue body

ERICSON EXCLUSIVE

"LIKE HAVING A METER IN EVERY PLUG..."

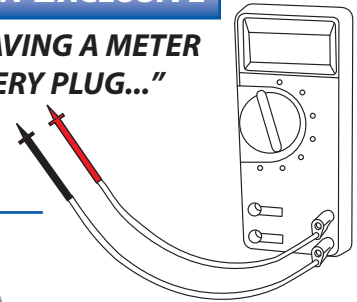

- No Ground
- Loss of Ground In Cord
- Hot/Neutral Swap
- Reverse Polarity
- Hot on Ground
- Open Neutral

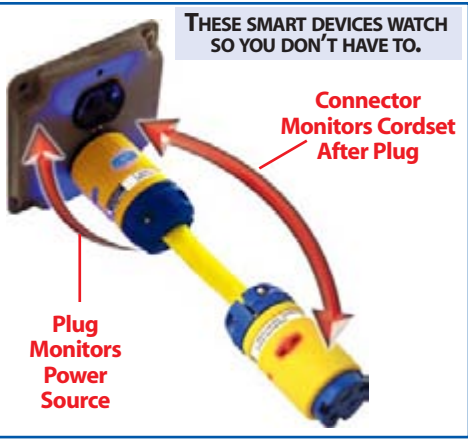

BLUE
OK TO USE



LEDs light up to let you know power is O.K.



24/7
Monitoring



RED
STOP, CALL AN ELECTRICIAN!

LEDs light up to let you know there is a problem

How It Works - Diagnostic Safety Cords

Economy Safe Cords



Cordset is OK to Use

- Safety earth ground is OK
- power polarity is OK



Do Not Use

- Check power source for proper wiring and ground
- Check cord for cuts, nicks etc.
- Check plug wiring
- Check connector wiring

Full Diagnostic Safety Cords*



X Do Not Use

- Source power is OK
- Check cord for cuts, nicks etc.
- Check connector wiring



Do Not Use

- Check power source for wiring or missing earth ground

Using SmartMonitor™ with Tool Cords

Blue OK to use tool**

Red STOP!

- Check power source for wiring or missing earth ground
- Check for miswired receptacle

* Full diagnostic safety cords give easy-to-understand indications which saves time tracking down electrical safety issues.

**This device does not diagnose any tool internal issues. This device is an indication that the power and safety earth ground are present.



Cord Clamp Style



Perma-Link™ Cord

Clamp Style Features:

- Internal cord seal
- Dual screw self-centering clamp
- Rubberized outer body

XXXX-PML

Cord Grip Style



Perma-Grip™ Cord Grip

Nut Style Features:

- Nickel plated solid brass blades
- Super sealing cord grip nut design



XXXX-PMGL

Water Tight Style



Perma-Tite2™ All Weather

Cord Grip Nut Style features:

- All weather - NEMA 6P rated
- Super sealing rings
- Nickel plated solid brass blades
- Super sealing cord grip nut design
- Connector includes cover
- 360° indication

XXXX-CW6PL

Plug & Connector Selection Guide

Face View	NEMA Configuration	Electrical Ratings		Perma-Link®		Perma-Grip®		Perma-Tite® 2	
		Amps	Volts	Plugs	Connectors	Plugs	Connectors	Plugs	Connectors
Straight Blade, 2-pole, 3-wire Grounding Devices									
	5-15	15	125	1510-PML	1610-CML	1510-PMGL	1610-CMGL	1510-PW6PL	1610-CW6PL
	5-20	20	125	1512-PML	1612-CML	1512-PMGL	1612-CMGL	1512-PW6PL	1612-CW6PL
Locking, 2-pole, 3-wire Grounding									
	L5-20	20	125	2310-PML	2410-CML	2310-PMGL	2410-CMGL	2310PW6PL	2410-CW6PL
	L5-15	15	125	1520-PML	1620-CML	1520-PMGL	1620-CMGL	1520-PW6PL	1620-CW6PL

New From Ericson... Industrial application SmartCords factory built to last and last. Models with Smart Connector (Economy Safe) and both Smart Plug and Connector are available. 24/7 monitoring with Assured Grounding Compliance to NEC and OSHA standards. Built with the highest quality materials to withstand your environment.



1510PML123A shown

Cord

Tough 600V rated SOW cordage for long lasting wear

SmartMonitor™ Connector

Checks entire cordset from the plug to the connector

Cordset Selection Guide

Economy Safe SmartCords P/N*	Length	Non-smart PLUG	Smart Connector	Cord Size	Rating
1610XXX143	A = 25ft B= 50Ft D=100ft	1510-__	1610-__L	#14/3 SOW	15A
1610XXX123		1510-__	1610-__L	#12/3 SOW	15A
1612XXX123		1510-__	1610-__L	#12/3 SOW	20A
2410XXX123		2310-__	2410-__L	#12/3 SOW	20A
Note: plug and connector type will be based on selection made of the master cordset part number - style will match					
Full Diagnostic Safety SmartCords P/N**	Length	Smart PLUG	Smart Connector	Cord Size	Rating
1510XXX143	A = 25ft B= 50Ft D=100ft	1510-__L	1610-__L	#14/3 SOW	15A
1510XXX123		1510-__L	1610-__L	#12/3 SOW	15A
1512XXX123		1512-__L	1610-__L	#12/3 SOW	20A
2310XXX123		2310-__L	2410-__L	#12/3 SOW	20A
Note: plug and connector type will be based on selection made of the master cordset part number					

* Replace XXX with: (Economy Cordsets Only)

CML = PermaLink Style Light Industrial Wiring Devices (non-smart Plug and Smart Connector installed)

CMGL = PermaGrip Style Industrial Wiring Devices with nickel plated blades (non-smart Plug and Smart Connector installed)

CW6PL = PermaTite Style Industrial All-Weather Wiring Devices (non-smart Plug and Smart Connector installed)

** Replace XXX with: (Full Diag Cordsets Only)

PML = PermaLink Style Light Industrial Wiring Devices (Smart Plug and Smart Connector installed)

PMGL = PermaGrip Style Industrial Wiring Devices with nickel plated blades (Smart Plug and Smart Connector installed)

PW6PL = PermaTite Style Industrial All-Weather Wiring Devices (Smart Plug and Smart Connector installed)



MANY ERICSON PRODUCTS ARE LISTED OR CERTIFIED.

FOR THE LATEST FULL SEARCHABLE LISTING BY PART NUMBER, GO TO: WWW.ERICSON.COM/AGENCY

Note: Products shown on this page may not be listed.



Perma-Tite® 2 Devices - Extreme Conditions

PERMA-TITE® 2 Plugs and Connectors

Perma-Tite®2 plugs and connectors are engineered and manufactured to the highest quality standards to provide the ultimate in electrical service and protection. They are designed and proven to do their best under the worst conditions in a broad array of the most severe food processing, industrial, marine, construction and petro-chemical work environments.

- UL Listed & CSA Certified, some ETL Listed
- Tongue & groove sealing system provides environmental protection of:
 - NEMA Type 4, 4X, 6, 6P & IP67
- Devices resist high-pressure hose down of 1,500 psi.
- Plug & Connector bodies made with PBT chosen for its high resistance to moisture absorption, high voltage arcing and carbon tracking
- Keyed body and cover for easy alignment/assembly
- Color coded sealing bushings are provided to fit a variety of cord diameters
- Removable/replaceable self-retained sealing cap provided with connector to keep out contaminants when not in use
- Nickel plated blades for corrosion resistance
- Transparent back-plate makes for quick visual wiring checks
- Ericson's new brilliant Blue and Radiant Yellow High Visibility Dual Color Safety System symbolizes that legendary Ericson Quality



All Black Available

NEMA TYPE 4, 4X, 6, 6P & IP67

- Excels in demanding outdoor & in-plant environments
- Resists hose directed water, the entry of water during prolonged submersion at a limited depth & damage from external ice formation

Typical Applications

- Food processing
- Pulp and paper mills
- Refineries and Petro Chem Facilities
- Ship yards
- Utilities
- Marine



16CW
Connector Cover Available

15PW
Plug Cover Available

PERMA-TITE® 2

EXTRA GROMMETS Color coded rubber cord sealer grommets supplied for a variety of diameters.

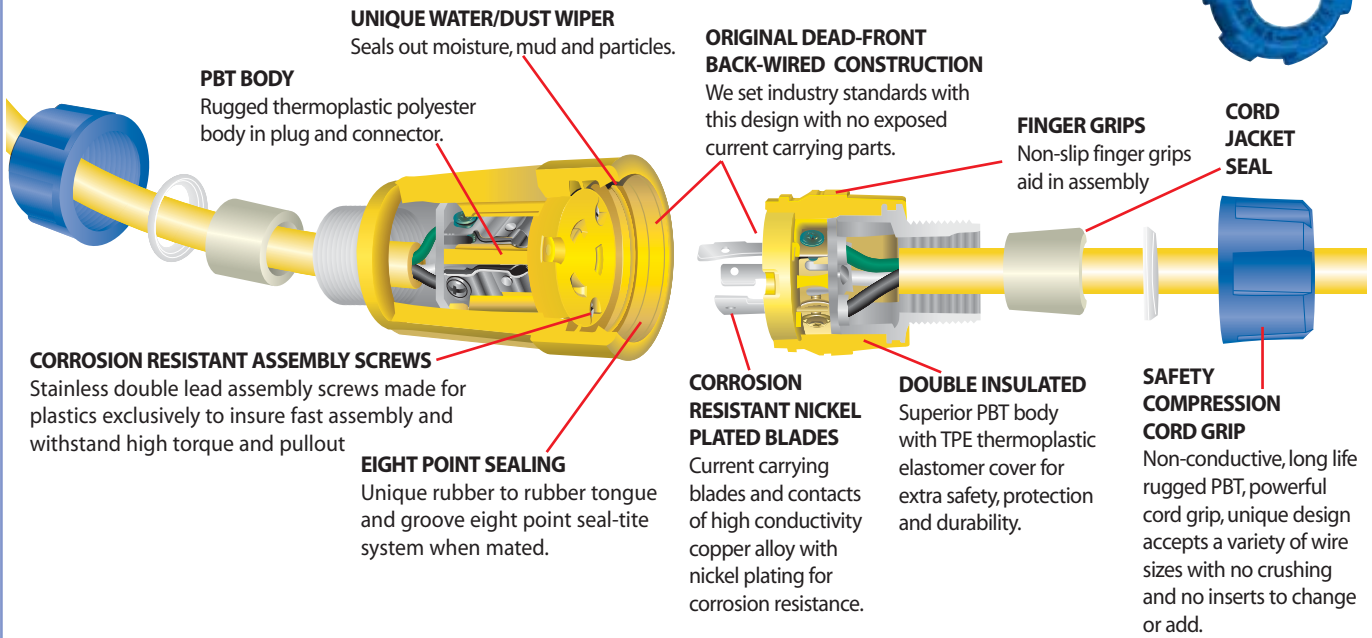

Note: Add - BLK for all black as available.



ERICSON EXCLUSIVE

PERMA-GRIP™ Plugs and Connectors

Ericson's industry exclusive design combines the Perma-Tite® cord grip with the industry proven design of its Perma-Link® devices to provide a line of **incredibly tough plugs and connectors** that stand up to the most demanding industrial and construction environments.

- UL Listed and CSA Certified, some ETL Listed
- Quick field assembly, no cable clamp screws to tighten, simply twist on the cord grip nut
- Water/mud/dust resistance provided by safety compression cord grips
- Keyed body and cover for easy alignment/assembly
- Color coded rubber cord-seal bushings accommodate a wide range of cable diameters
- Molded-in non-slip fingers grips makes devices easy to assemble and handle
- Withstand high impact, corrosion, oils, greases, solvents and other chemicals across -20 °C - +65 °C
- Nickel plated brass blades and ground pin stops corrosion and keeps solid electrical contact

- Individual wire pockets help prevent flashovers
- Transparent back plate speeds wiring inspection
- Selected models available with Ground Continuity Monitor
- Available individually or on factory assembled cord sets
- Flexibility of reverse-cover design (straight blade devices) creates weather-resistant connections by interchanging covers
- Ericson's exclusive Brilliant Blue and Radiant Yellow High Visibility Dual Color Safety System



All Black Available



Complete Kit as Shown

FEATURE

Safety Compression Cord Grip

Non-conductive, long life rugged PBT, powerful cord grip, unique design accepts all AWG wire range sizes from #18 through #12 with no crushing and no inserts to change or add

High-Visibility Safety Colors
Added safety in dull work areas With Brilliant Blue and Radiant Yellow colors.

Transparent Back Plate

Clear polycarbonate permits visual wiring inspection without disassembly

FEATURE!

Internal Cord Seal
Built-in cord entrance seal in cover seals out moisture and most foreign material that can cause short circuit.

Keyed PBT Body

Adds to quick alignment and assembly.

Double Insulated

Superior PBT body with TPE thermoplastic elastomer cover for extra safety, protection and durability.

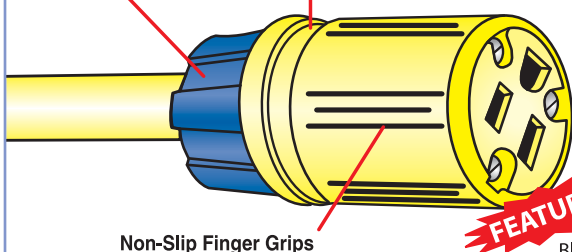

Non-Slip Finger Grips

NEW! Combo Head

Blades nickel plated to prevent corrosion

Captive Assembly Screws

Double lead screws provide rigid assembly, no bulging of cover, maximum pull out resistance, fast assembly.

Individual Wire Chambers

Accepts up to #12 AWG conductors and prevents flash overs and short circuits.

EXTRA GROMMETS Color coded rubber cord sealer grommets supplied for a variety of diameters.



Dead-Front Back-Wired Design

We set industry standards with this design, no exposed current carrying parts, meets NEC article #410-56 (d).

Note: Add - BLK for all black as available.



MANY ERICSON PRODUCTS ARE LISTED OR CERTIFIED.

FOR THE LATEST FULL SEARCHABLE LISTING BY PART NUMBER, GO TO: WWW.ERICSON.COM/AGENCY

Note: Products shown on this page may not be listed.





PERMA-LINK® Plugs and Connectors

United States patent number 4,021,092 was assigned to today's Perma-Link® plugs and connectors which are classified among the most rugged and safest wiring devices available. They incorporate many of the same features as Ericson Perma-Tite® 2 and Perma-Grip™ devices and utilize a two-screw cable clamp. Perma-Link® plugs and connectors are designed to provide many years of trouble-free service in the most demanding industrial and construction environments.

- UL Listed and CSA Certified
- Two-screw cable clamp secures wire and provides strain-relief
- Solid brass blades for optimum electrical and mechanical performance
- Keyed body and cover for easy alignment/assembly
- Molded-in non-slip finger-grips makes devices easy to assemble and handle
- Withstand high impact, corrosion, oils, greases, solvents and other chemicals across -20 °C to 100 °C
- Individual wire pockets help prevent flashovers
- Transparent back plate speeds wiring inspection
- Selected models available with Ground Continuity Monitor
- Available individually or on factory assembled cord sets
- Flexibility of reverse-cover design creates weather-resistant connections by interchanging covers
- Ericson's exclusive Brilliant Blue and Radiant Yellow High Visibility Dual Color Safety System

All Black Available

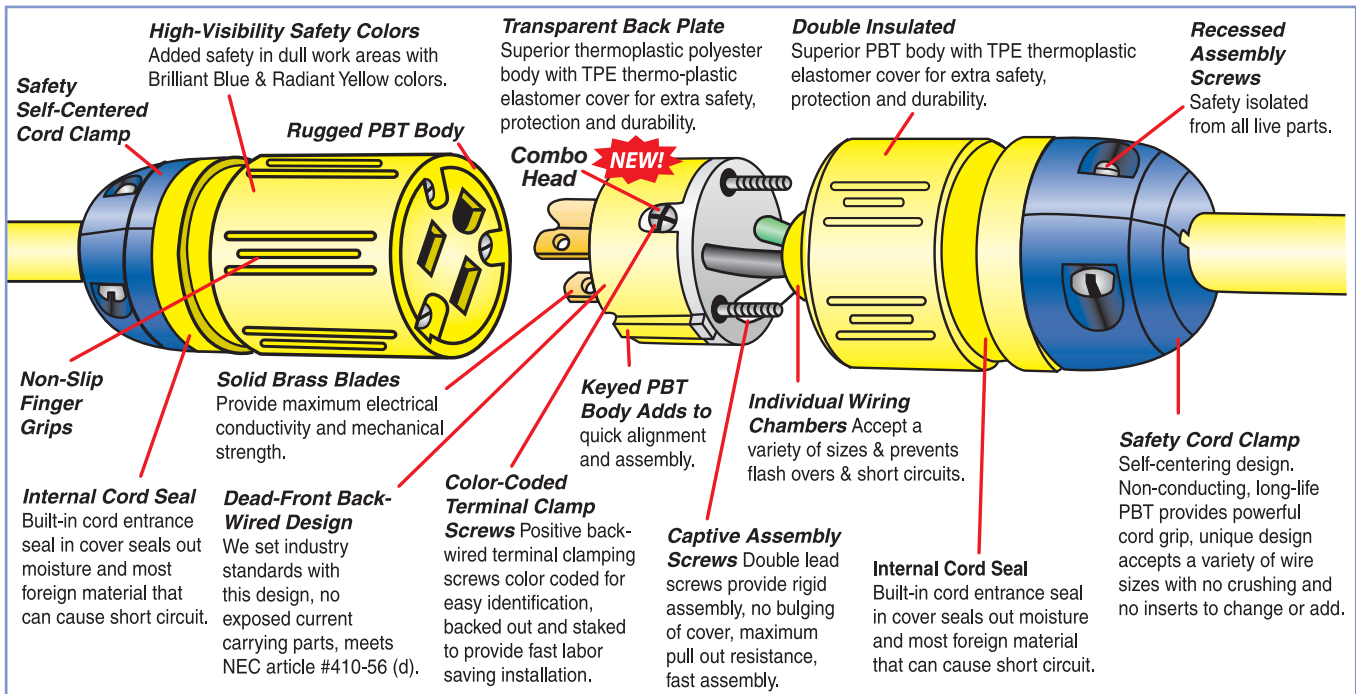
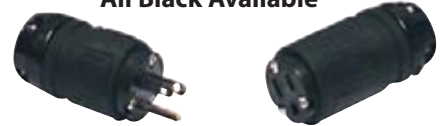

Note: Add - BLK for all black as available.



Versatile Weather-Resistant Field Conversion

Our Perma-Link® plugs and connectors (as listed below) are designed so they can easily be converted to create weather-resistant connections by interchanging the internal assemblies. Insert the plug body into the connector cover, and the connector body into the plug cover. There are no extra parts to purchase.

Step 1:

Disassemble The Plug & Connector As Shown

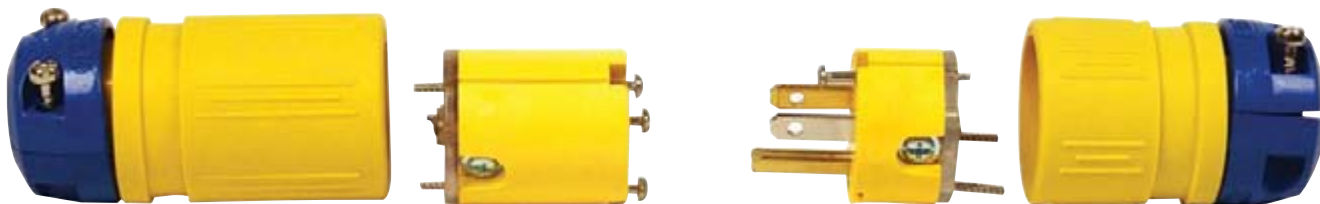

Step 2:

Swap Plug & Connector Assemblies

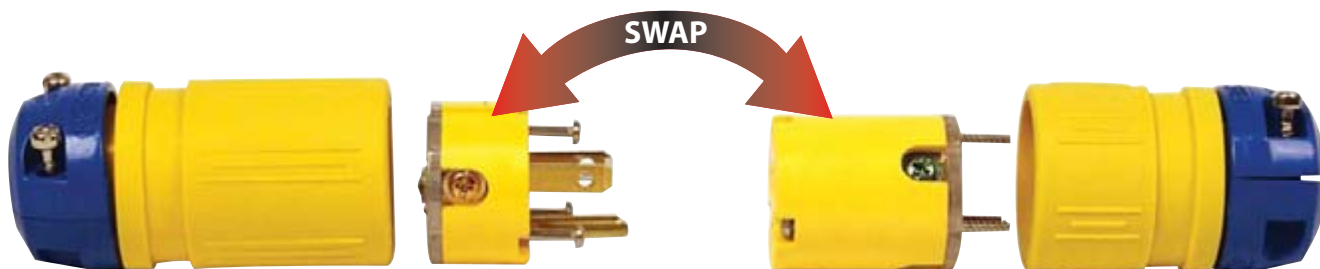

Step 3:

Assemble Cords Per Bag Instructions

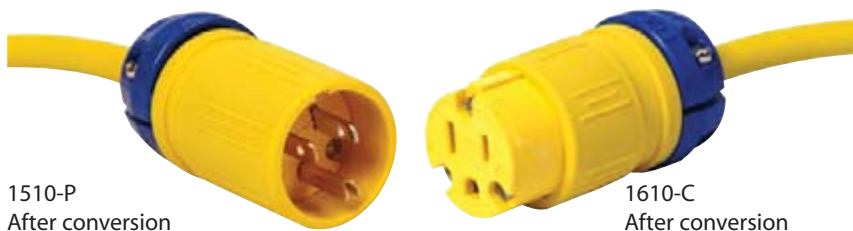

Convertible Parts	
1510-P	1610-C
1512-P	1612-C
1514-P	1614-C



Now Your Perma-Link® Plugs & Connectors Are More Weather Resistant!



MANY ERICSON PRODUCTS ARE LISTED OR CERTIFIED. FOR THE LATEST FULL SEARCHABLE LISTING BY PART NUMBER, GO TO: WWW.ERICSON.COM/AGENCY
 Note: Products shown on this page may not be listed.

